

CR Series



TECHNICAL DATA

	CR15	CR30	CR30-H
Max Capacity	1500 kg	3000 kg	3000 kg
Max longitudinal gradient	40°	40°	40°
Max laterall gradient	30°	30°	30°
Width	775 mm	795 mm	920 mm
Length	1390 mm	1750 mm	1925 mm
Track length	876,5 mm	1236,5 mm	1515 mm
Track width	180 mm	200 mm	250 mm
Ground clearance	44 mm	43 mm	240 mm
Max speed	3,5 km/h	3,5 km/h	3,5 km/h
Power of electric motors	2,75 kW	4,4 kW	4,4 kW
Voltage	48 V	48 V	48 V
Lithium Battery capacity	60 Ah STD	120 Ah STD	120 Ah STD
	60Ah optional	60Ah optional	60Ah optional
Ingress Protection IP	IP67	IP67	IP67
Controller	RADIO	RADIO	RADIO
Gross weight	380 kg	495 kg	690 kg

OVERALL DIMENSIONS CR15

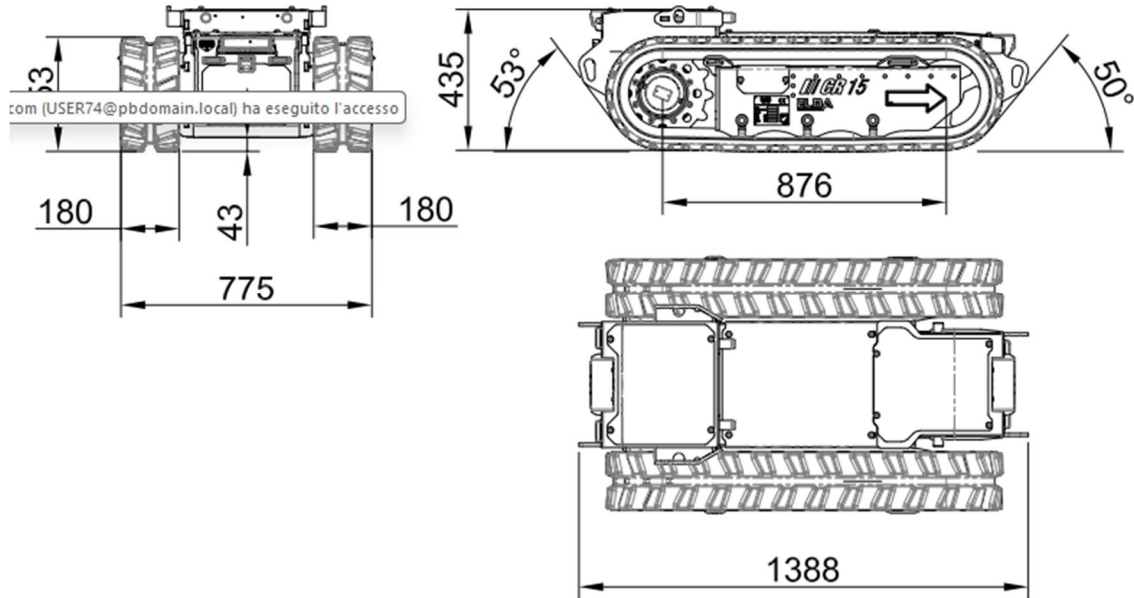

OVERALL DIMENSIONS CR30

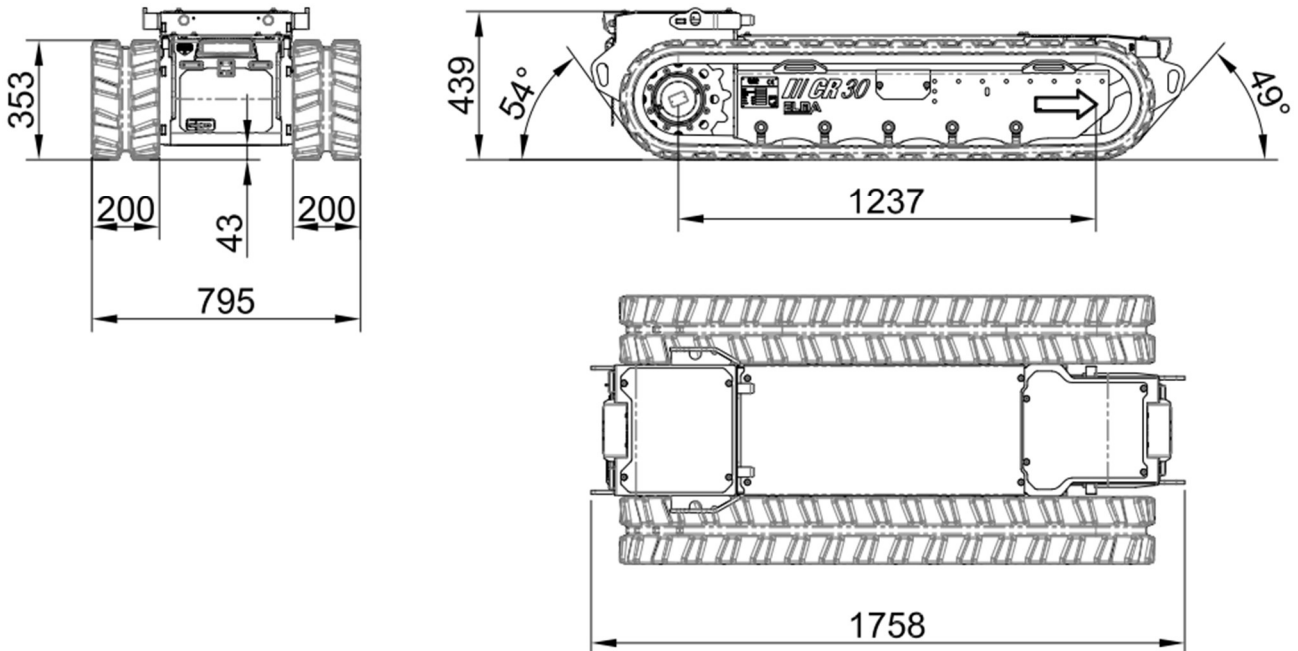

OVERALL DIMENSIONS CR30-H

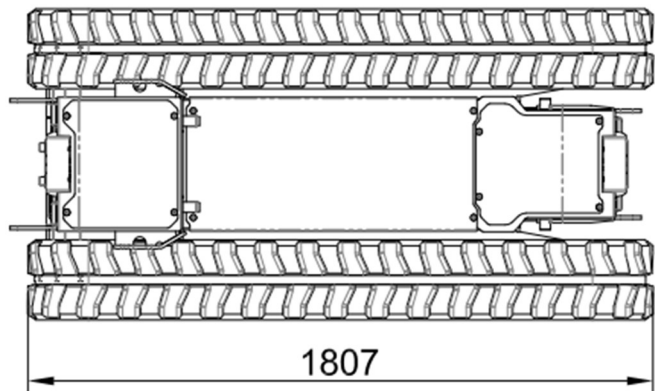
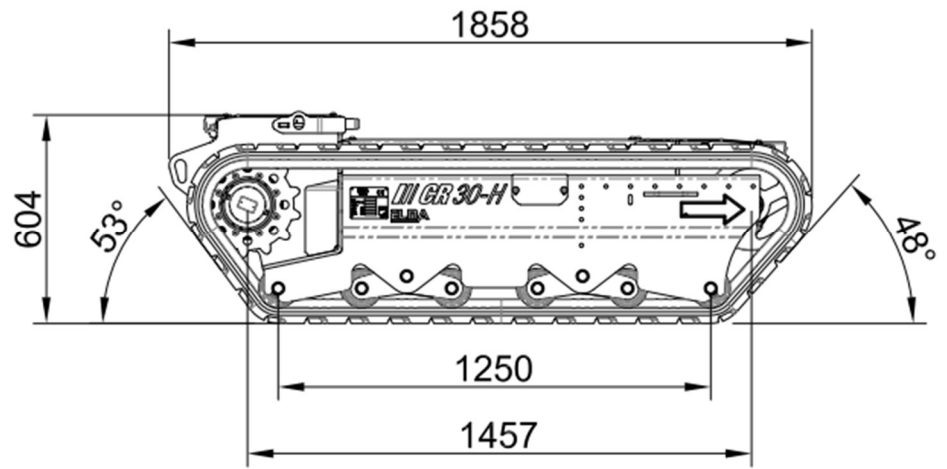
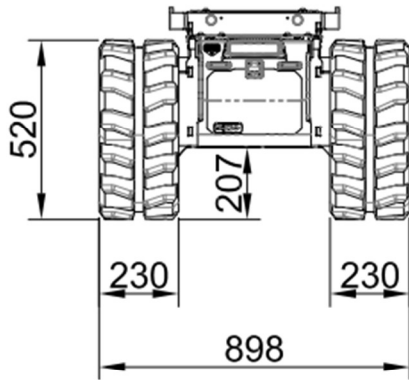

ATTACHMENTS

1. TURNABLE/FIXED PALTFROM 1650x740

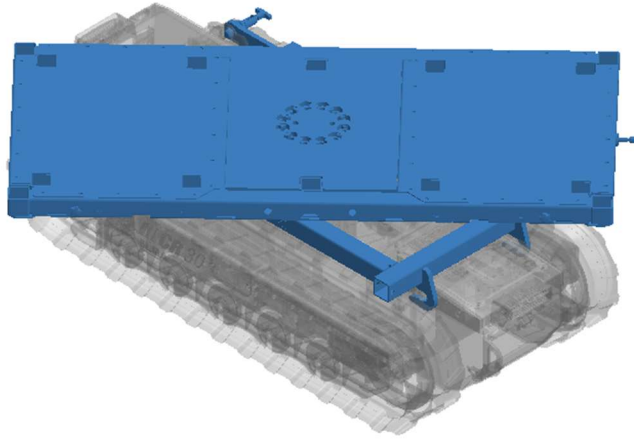

Max Capacity	3000 kg
Weight	190 kg
VALID FOR	CR30; CR30-H

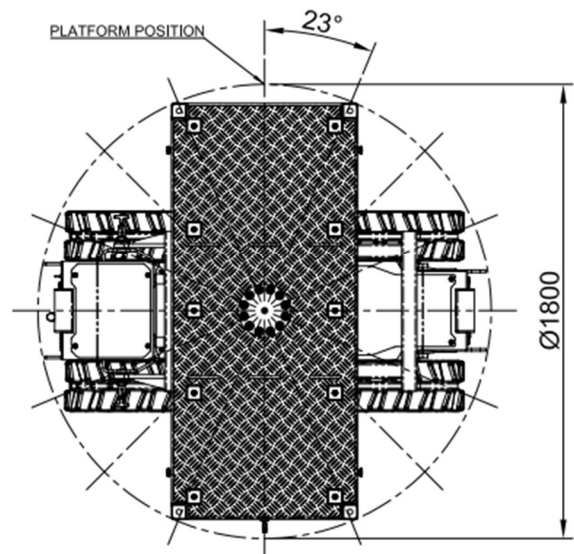
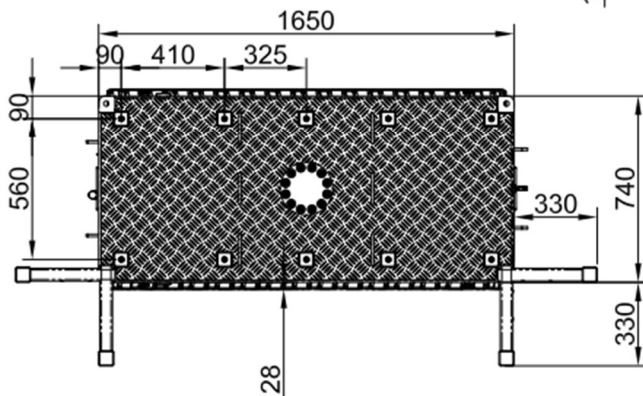
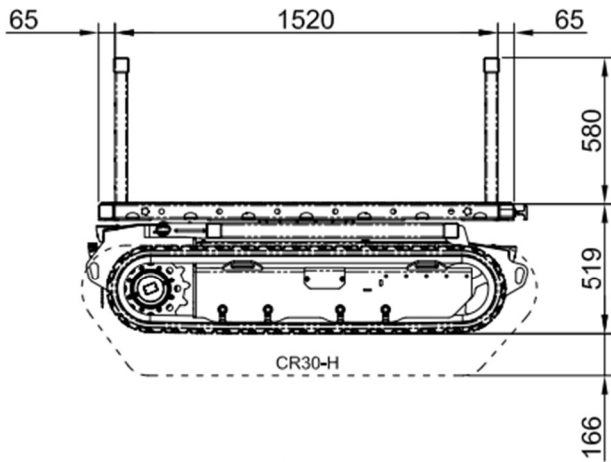

2. TURNABLE/FIXED PALTFROM 1300x740

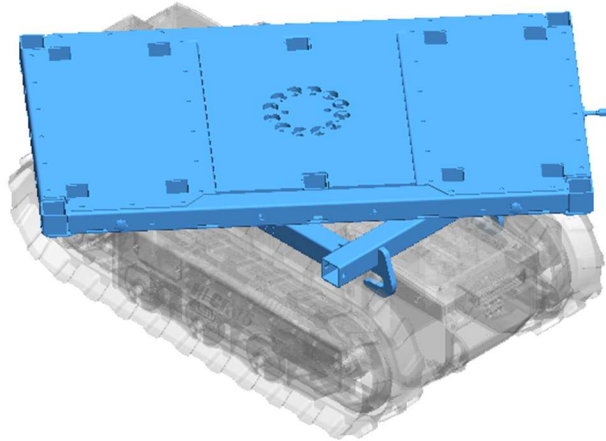

Max Capacity	1500 kg
Weight	175 kg
VALID FOR	CR15

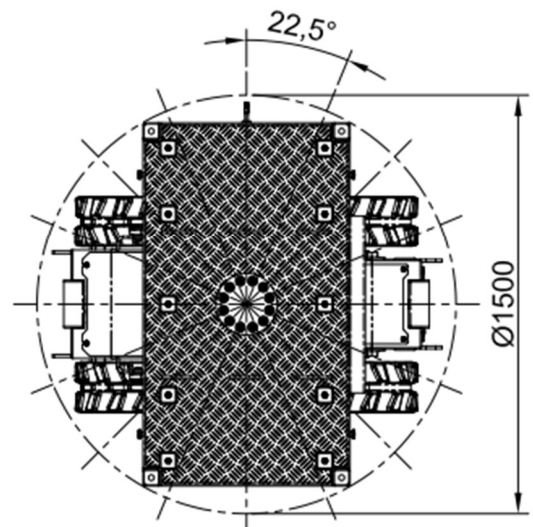
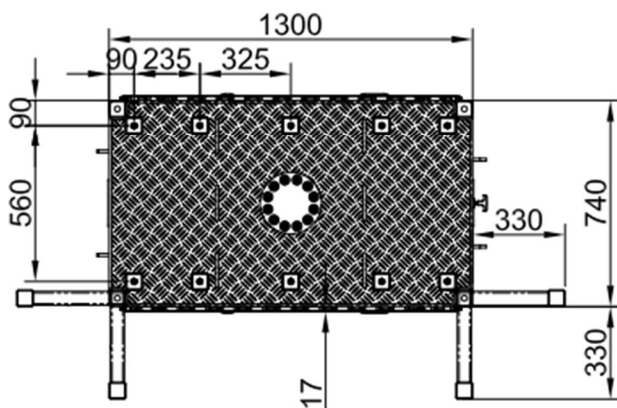
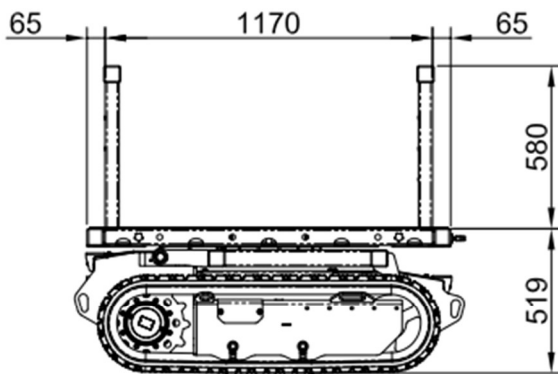

3. FOREST KIT

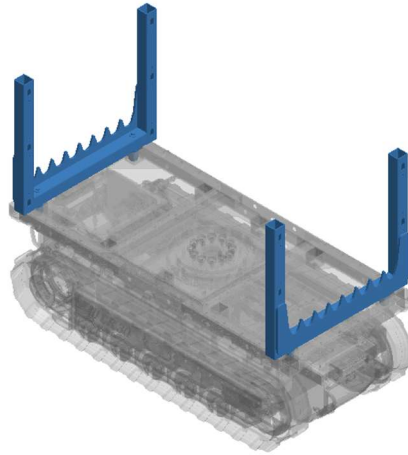

	CR30	CR30-H	CR15
Max Capacity	1450 kg	2950	
Weight	50 kg		

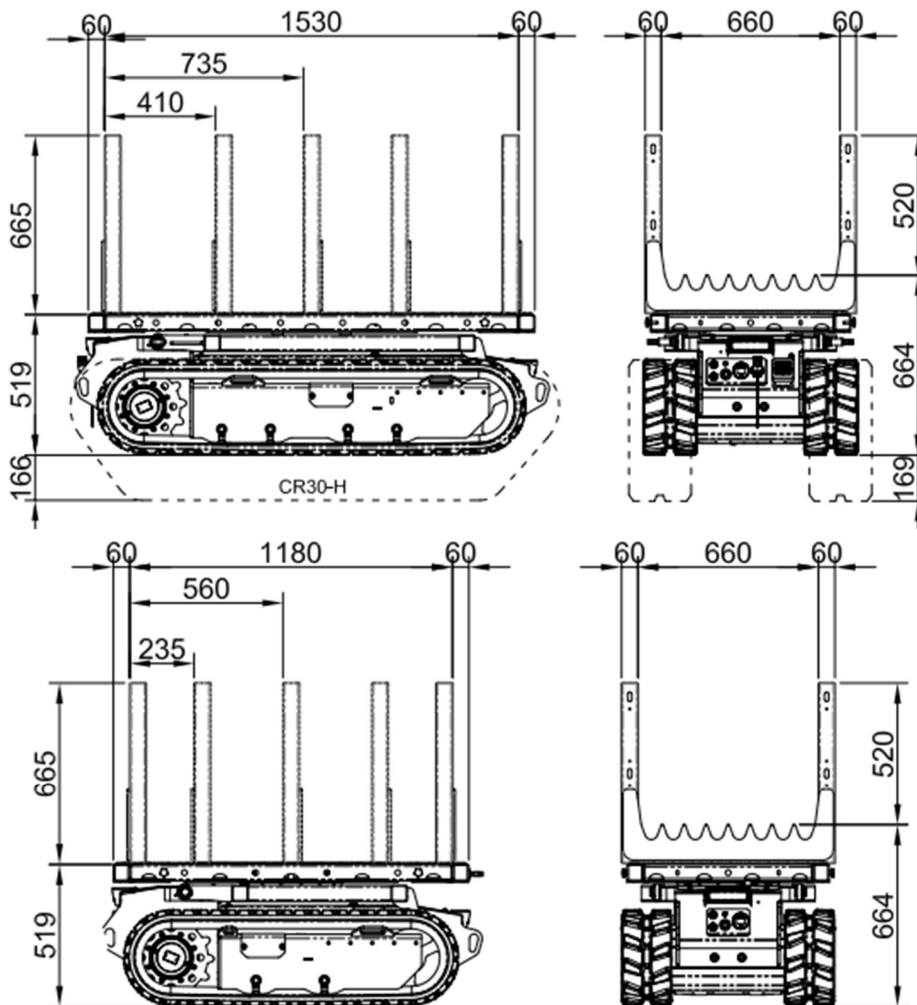

4. GLASS SHEET TRANSPORT KIT.

	CR15	CR30	CR30-H
Max Capacity	1375 KG	2875 KG	
Weight	125 kg		

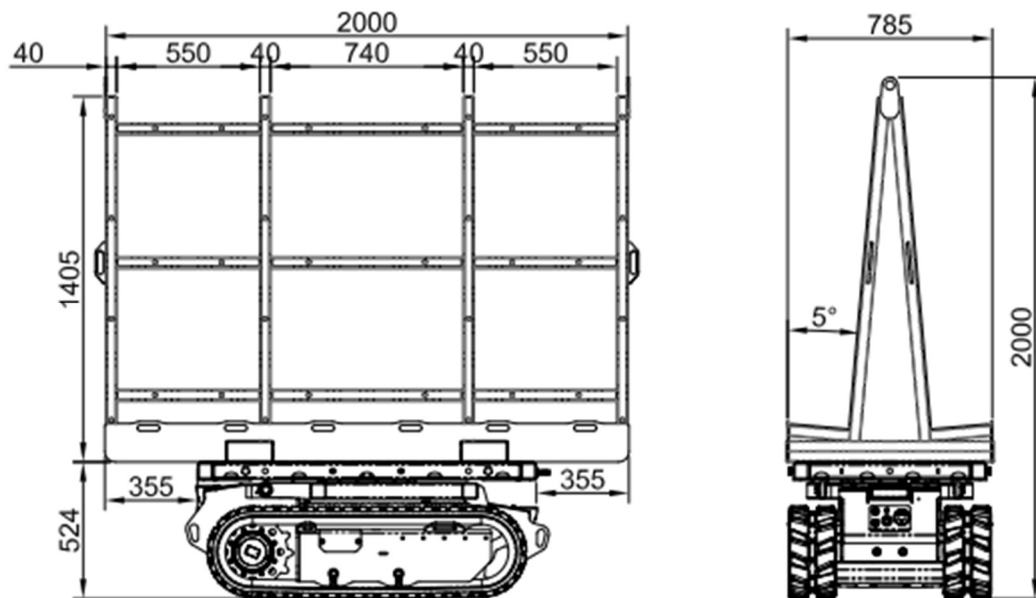
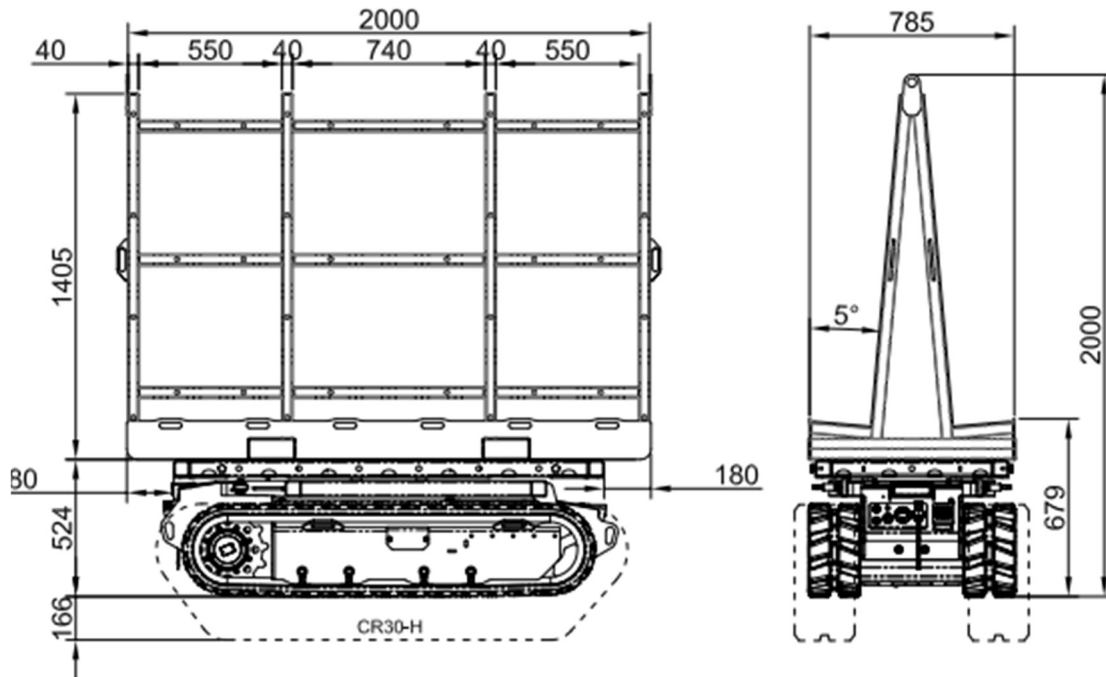

5. EXTRA-LONG LOADS TRANSPORT KIT

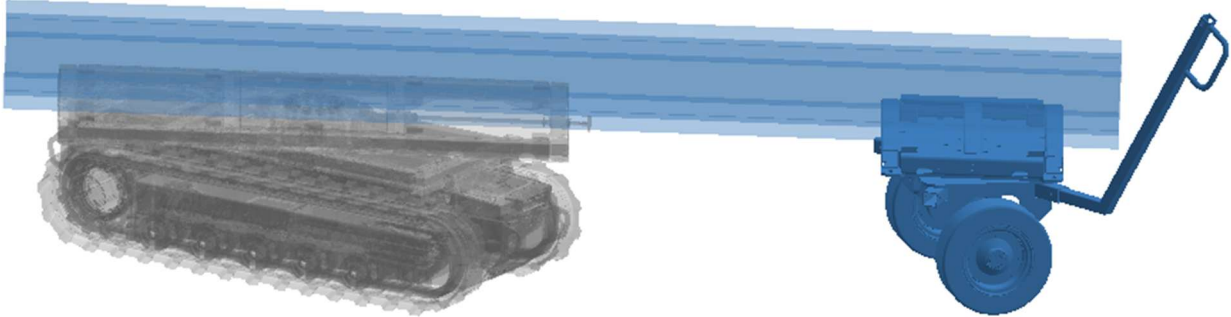

Max Capacity	2400 kg
Weight	130 kg
VALID FOR	CR15; CR30

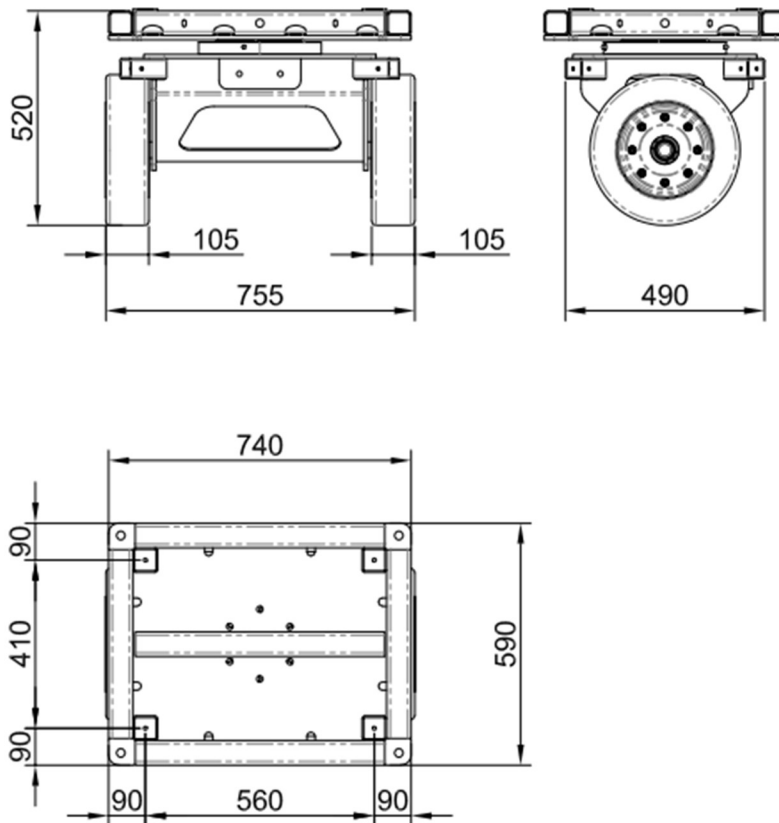

OPTIONALS

1. ADDITIONAL BATTERY



Automotive grade cells
from top tier manufacturers



Fast charging
within 3 hours



Long shelf life performance
with shutdown mode



Cold temperature functionality
(-35°C) with optional integrated heater



Certified to ECE R100/R10
for EU on-road electric vehicle applications



- Supports regenerative braking
- Soft start control (System pre-charge)
- Patented virtual BMS with Advanced Module Balancing Technology
- Universal Communication Protocol (CANopen/J1939)
- UL2580 Shock & Vibration + Thermal Propagation Mitigation
- Compatible with many off-the-shelf chargers

Electrical Specifications

Cell Chemistry	Nickel Cobalt Manganese
Pack Voltage (Nom/Max)	51.7V / 58.1V
Pack Energy	3.2kWh (62Ah)
Specific Energy	169Wh/kg
Continuous Power	3.1kW (60A)
Recommended Charge CCCV	20A / 58.1V
Peak Power (<10sec)	7.24kW (140A)
Cycle Life (@ 25°C)	2,000 @ 80% DoD
Scalability	Up to 10 packs in parallel

Operational Specifications

Charge Temp	0°C to 45°C -35°C to 45°C (w/ heater)
Discharge Temp	-20°C to 55°C -35°C to 55°C (w/ heater)
Storage Temp	-20°C to 60°C
Humidity (Operating)	5% to 95%
Humidity (Storage)	<70%

Mechanical Specifications

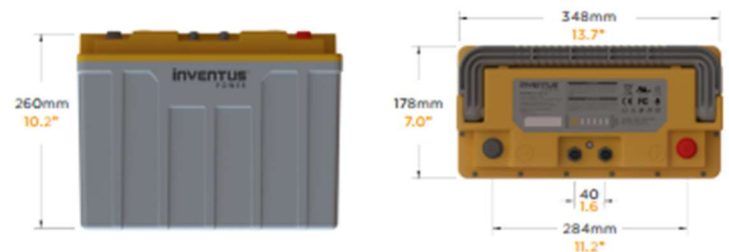

BCI Size	Group 5D
Terminal Type (ISO)	M8 (Neg), M10 (Pos)
Terminal Torque (Nm)	17 ± 1 (Neg), 22 ± 1 (Pos)
Weight	19.0kg (41.9lbs)
Installation Orientation	Horizontal / Vertical
Ingress Protection Rating	IP67*
Case Flammability Rating	Flame Retardant UL94 V-0

Certifications

- UL2580 (Cell)
- UL2271 (Pack)
- IEC62133 (Cell/Pack)
- IEC62619
- IEC60730 Class B
- FCC Class B
- CE
- UN38.3
- ECE R100
- ECE R10

2. SUPPORT FOR ATTACHMENTS

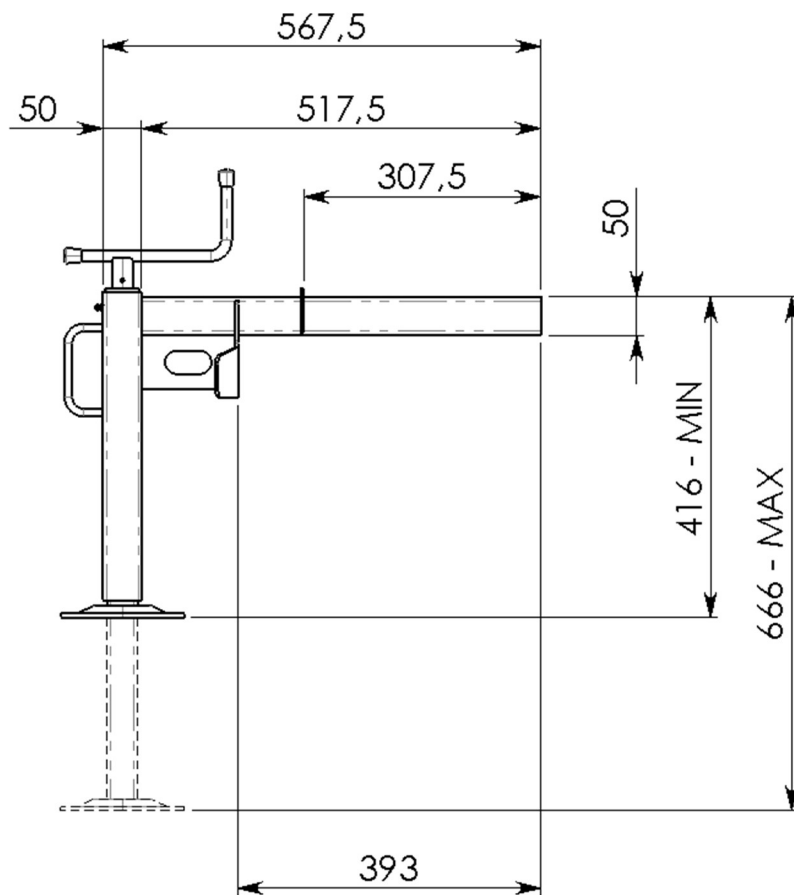
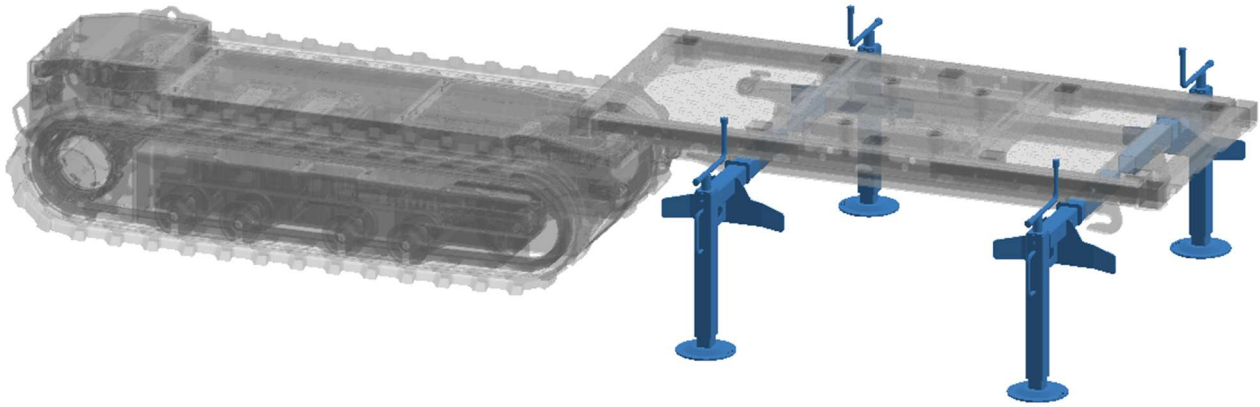

3. RADIO REMOTE CONTROL

AUTEC BASIC (standard)



SCANRECO BASIC-PREMIUM (optional)



